

350Z-CROD

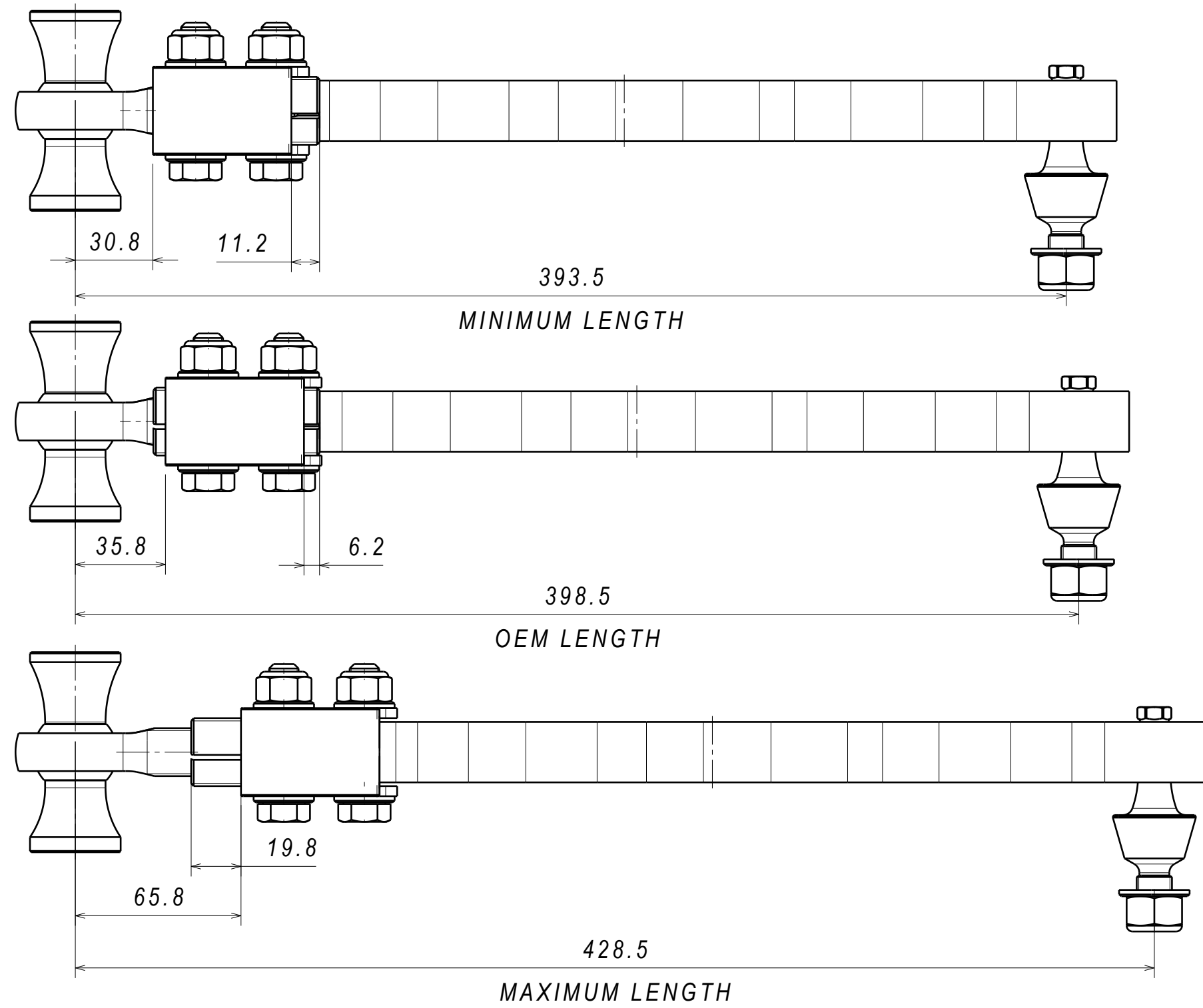

12 mm HEX
APPLY MEDIUM STRENGTH THREAD LOCK (LOCTITE 243)
TIGHTEN TO 50Nm (32ft-lb)

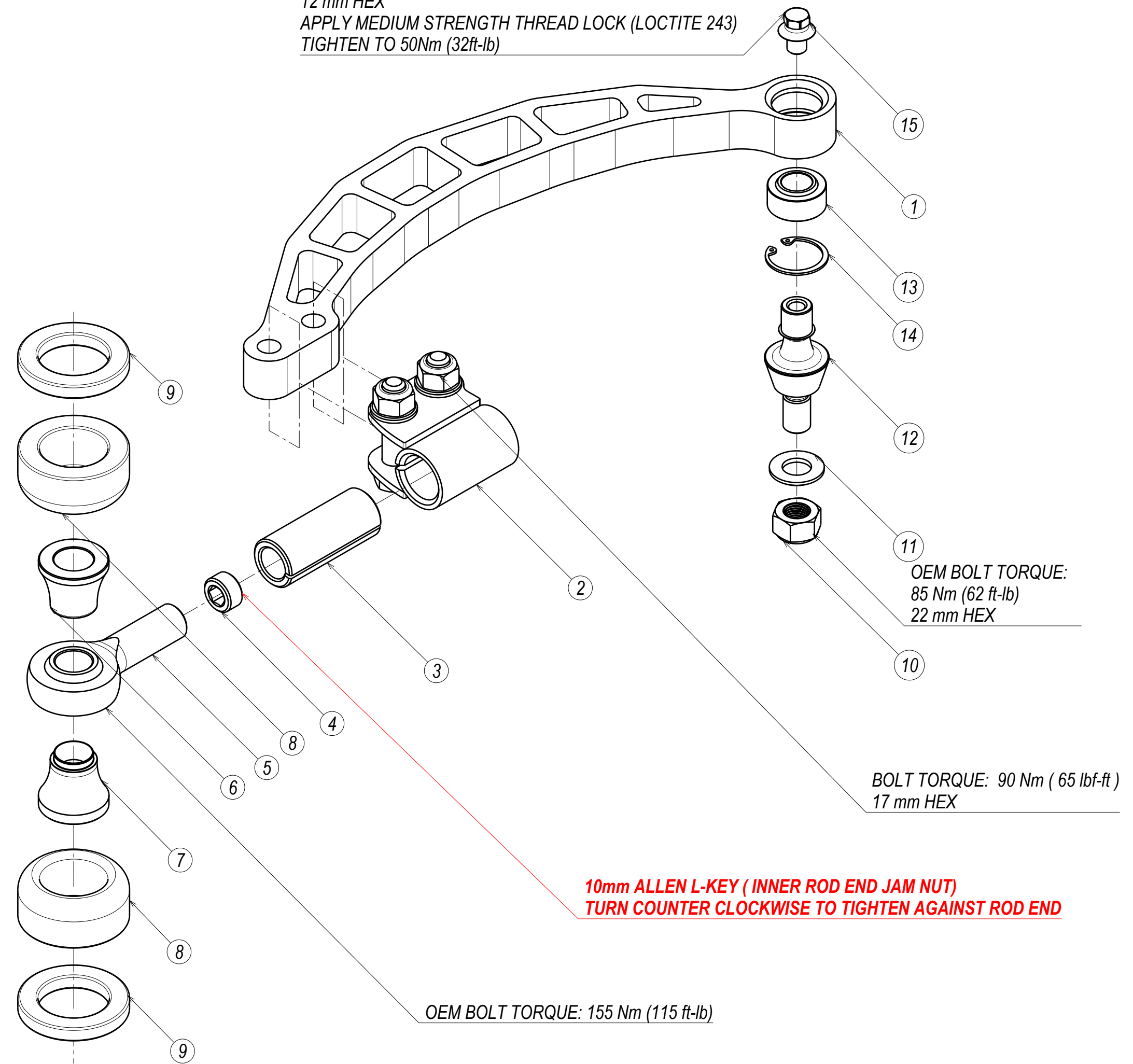

15	350Z FRONT TOP A-ARM BEARING BOLT	1
14	DIN 472 30x1.2 RETAINING RING STEEL	1
13	QA1 SPHERICAL BEARING COM10T	1
12	350Z REAR UPPER A-ARM TAPERED BOLT	1
11	ISO 7089 WASHER 14x28 STEEL GRADE A PLAIN ZN HOT	1
10	DIN 985-8 M14x1.5 NYLON LOCKING NUT	1
9	SPACER 36x57x8	2
8	350Z COMPRESSION ROD PILOT BUSHING	2
7	ROD END SPACER PCML12T 14ID 80W	1
6	ROD END SPACER PCML12T 20ID 80W	1
5	PCML13T-S ROD END	1
4	INTERNAL JAM NUT 3/4-16 UNF	1
3	VERNIER SLEEVE - 3/4 TO M27 INTERNAL DRIVE	1
2	M27-24 PINCH BRACKET ADJUSTER ASM	1
1	350Z COMPRESSION ROD BODY R/H	1
PC NO	COMPONENT NAME	QTY

CRITICAL!

CHECK FOR ROD END BEARING ALIGNMENT
AFTER TIGHTENING THE ADJUSTING MECHANISM
ROD END TO BE PERPENDICULAR TO THE SPACERS

