

# FG8X-CBSH

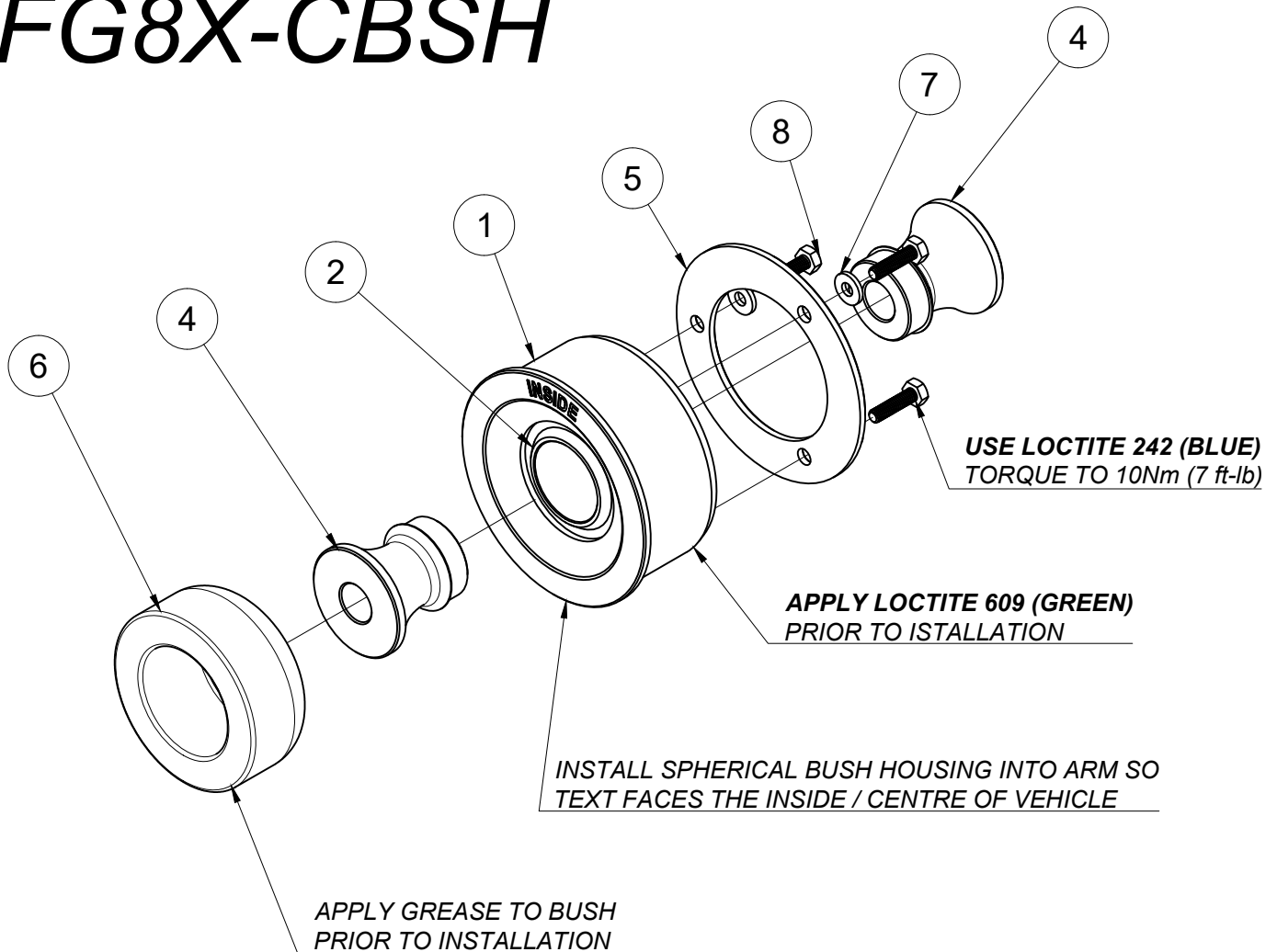

1. REMOVE CASTER ARM FROM THE VEHICLE.
2. USE A PRESS TO REMOVE THE OEM BUSH.
3. CLEAN THE INNER SURFACE TO PREPARE IT FOR THE NEW BUSH.
4. APPLY LOCTITE 609 (BEARING RETAINER), TO THE INNER SURFACE OF THE ARM. ALIGN THE "INSIDE" TEXT TO THE INNER SIDE OF THE ARM.
5. PRESS THE BUSH HOUSING INTO THE ARM. (ALTERNATIVELY USE A RUBBER Mallet OR A HAMMER AND WOODEN BLOCK).
6. GREASE THE POLYURETHANE BUSH AND RE-INSTALL THE ARM USING THE SPACERS AS SHOWN IN THE ABOVE DIAGRAM.
7. REPEAT STEPS 1-6 FOR THE OTHER SIDE OF THE VEHICLE.

8	M4 STAINLESS STEEL BOLT	6
7	M4 x 16 STAINLESS STEEL WASHER	6
6	PILOT BUSHING	2
5	SAFETY RETENTION PLATE	2
4	HIGH MISALIGNMENT SPACER	4
3	1-3/4 INCH ID CIRCLIP	2
2	COM16T SPHERICAL BEARING	2
1	SPHERICAL BEARING HOUSING	2
<b>ITEM</b>	<b>DESCRIPTION</b>	<b>QTY</b>
<b>PARTS LIST:</b>		