

# S13X-CSTR / S14X-CSTR

## SUGGESTED ARM LENGTH ADJUSTMENT MEASUREMENTS

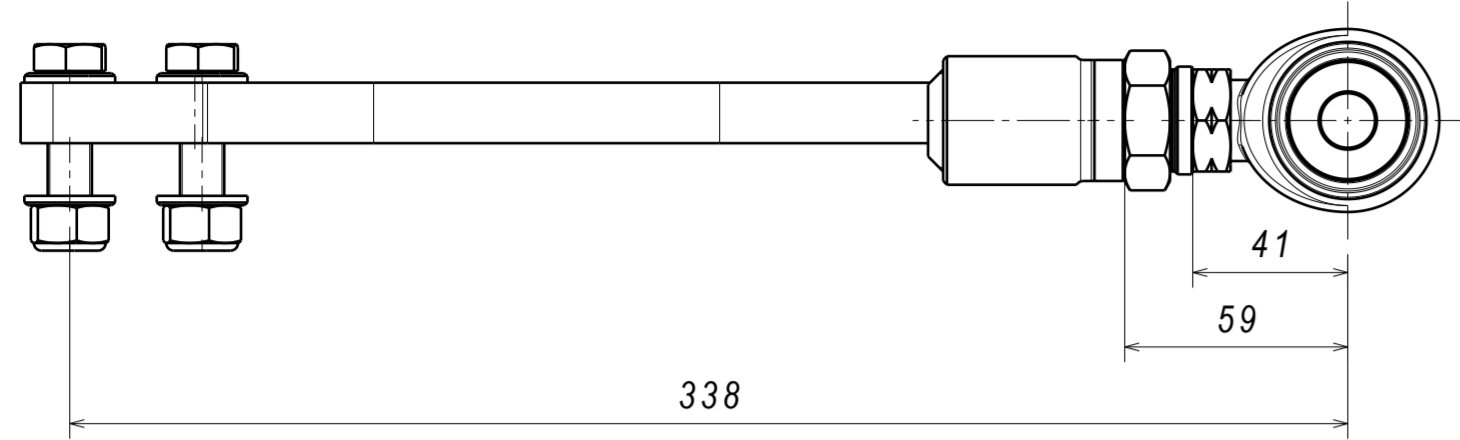

S13 MINIMUM LENGTH - 338 mm  
S14 MINIMUM LENGTH - 360 mm  
(MEASURED BETWEEN HOLE CENTERS)

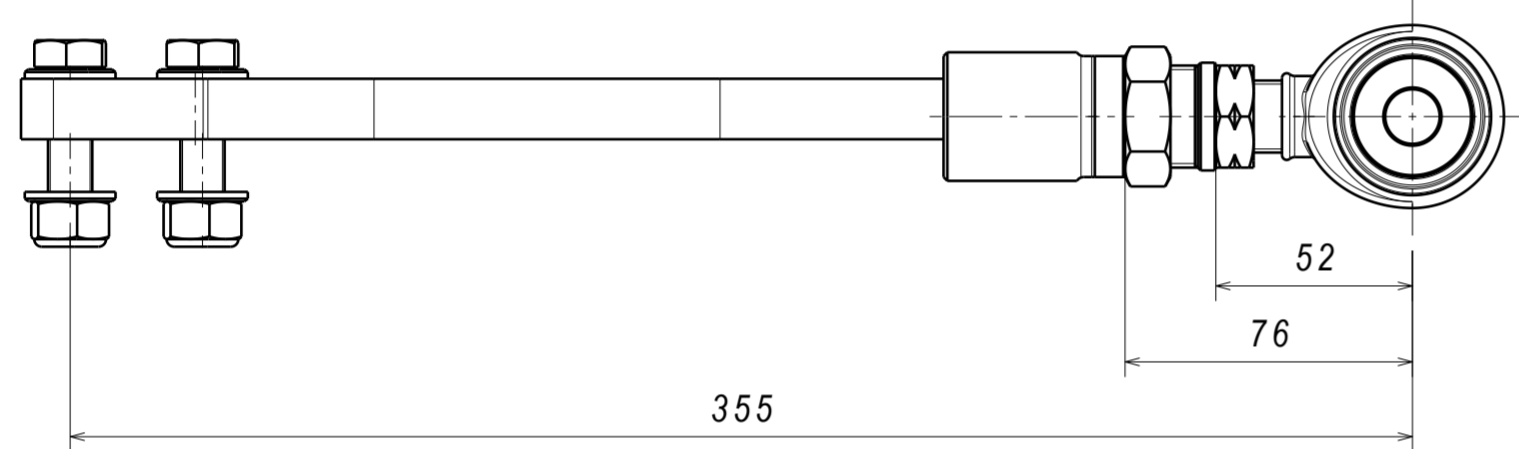

S13 OEM LENGTH - 355 mm  
S14 OEM LENGTH - 377 mm

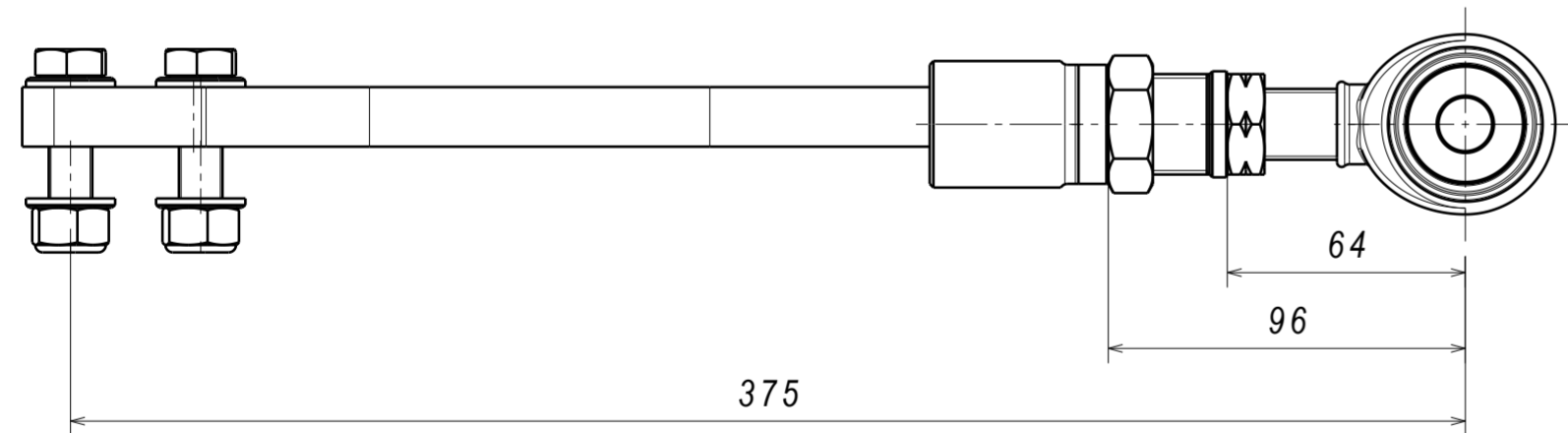

S13 MAXIMUM LENGTH - 375 mm  
S14 MAXIMUM LENGTH - 397 mm

## CRITICAL!

CHECK FOR ROD END BEARING ALIGNMENT  
AFTER TIGHTENING THE ADJUSTING MECHANISM  
ROD END TO BE PERPENDICULAR TO THE SPACERS

