

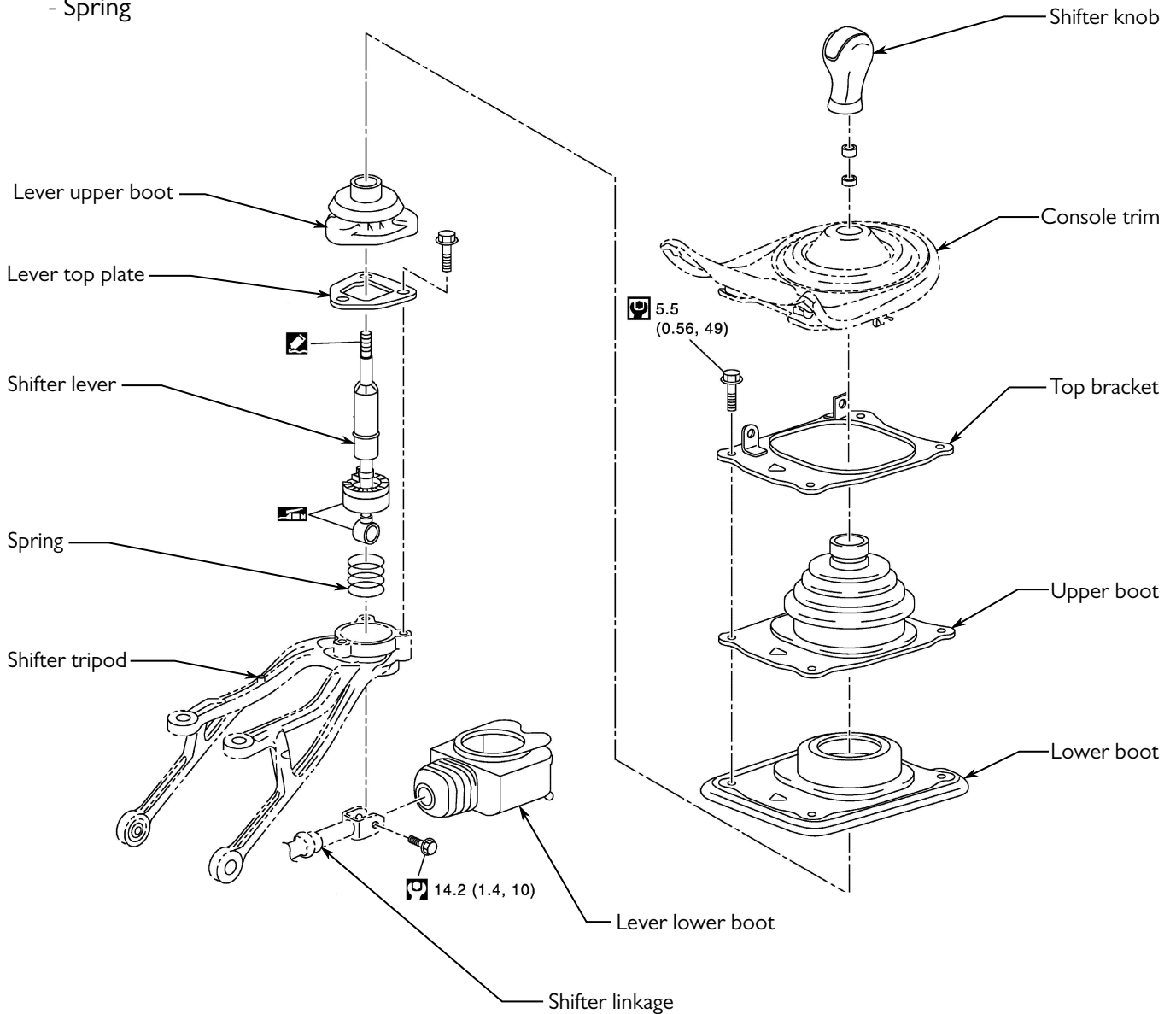

350Z / 370Z SHORT SHIFTER ASSEMBLY GUIDE

1. Begin by placing the car on a hoist or jack stands with adequate room to access the gearbox
2. Remove the following parts:
 - Shifter knob
 - Console trim
 - Top bracket
 - Upper boot and Lower boot
3. Under the car, peel back the lever lower boot
3. Remove the shifter lever lower bolt
4. Back inside the car, remove the remaining parts:
 - Lever upper boot
 - Lever top plate
 - Shifter lever
 - Spring





350Z / 370Z SHORT SHIFTER ASSEMBLY GUIDE

1. Support the gearbox with transmission jack
2. Remove 4 x bolts from cross member
3. Lower the transmission to improve access to the 2 x top tripod bolts

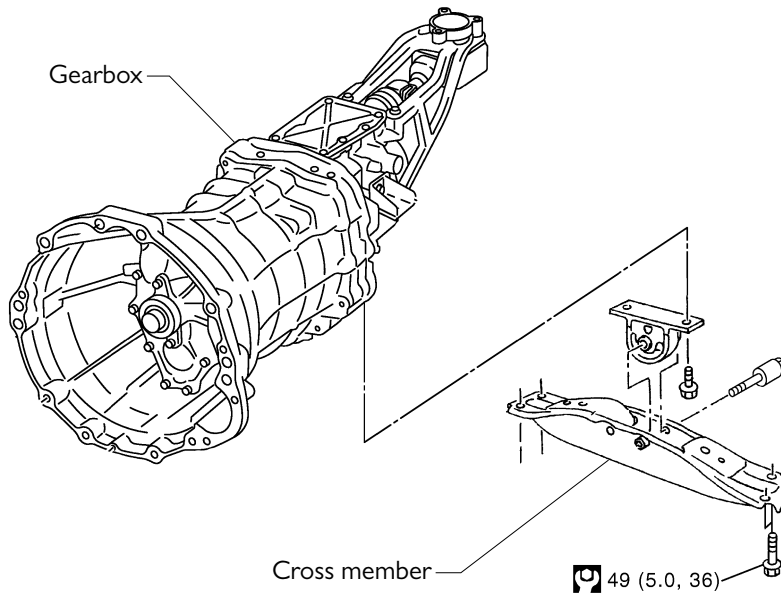

4. Remove 4 x tripod bolts from the gearbox
5. Remove the OEM tripod bracket

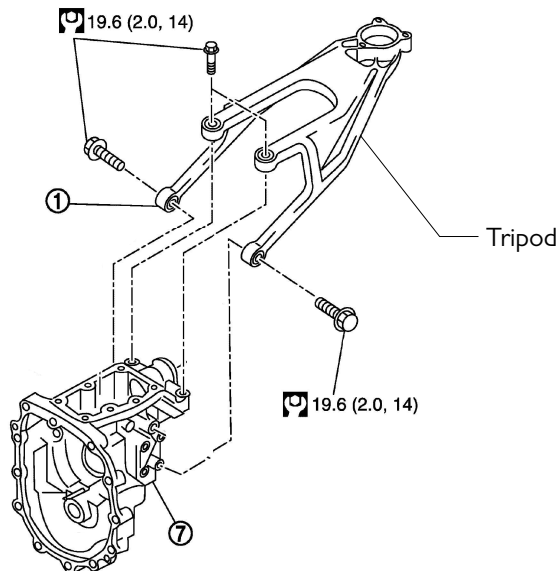



350Z / 370Z SHORT SHIFTER ASSEMBLY GUIDE

1. Install Shifter lever ASM onto Base plate using the 4 x M6 bolts supplied
2. Use medium strength thread locker **Loctite 243** or equivalent

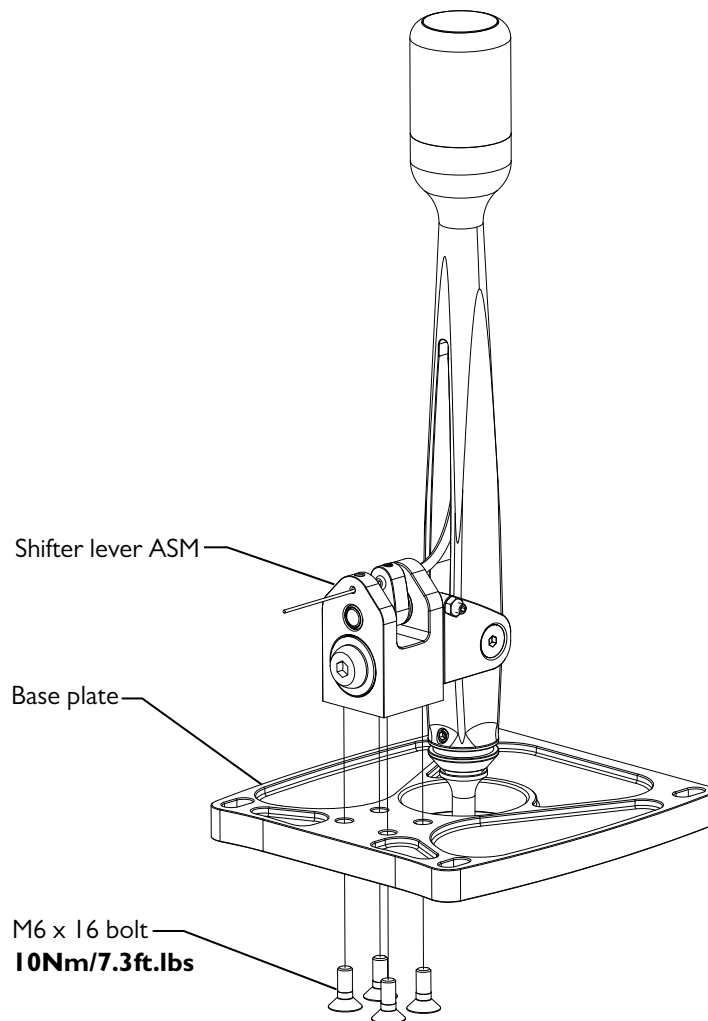



350Z / 370Z SHORT SHIFTER ASSEMBLY GUIDE

1. Install onto the transmission tunnel using the supplied 4 x M6 x 30 bolts
2. Install the Shifter lever boot between the Base plate and Lever, fixing in place with a cable tie

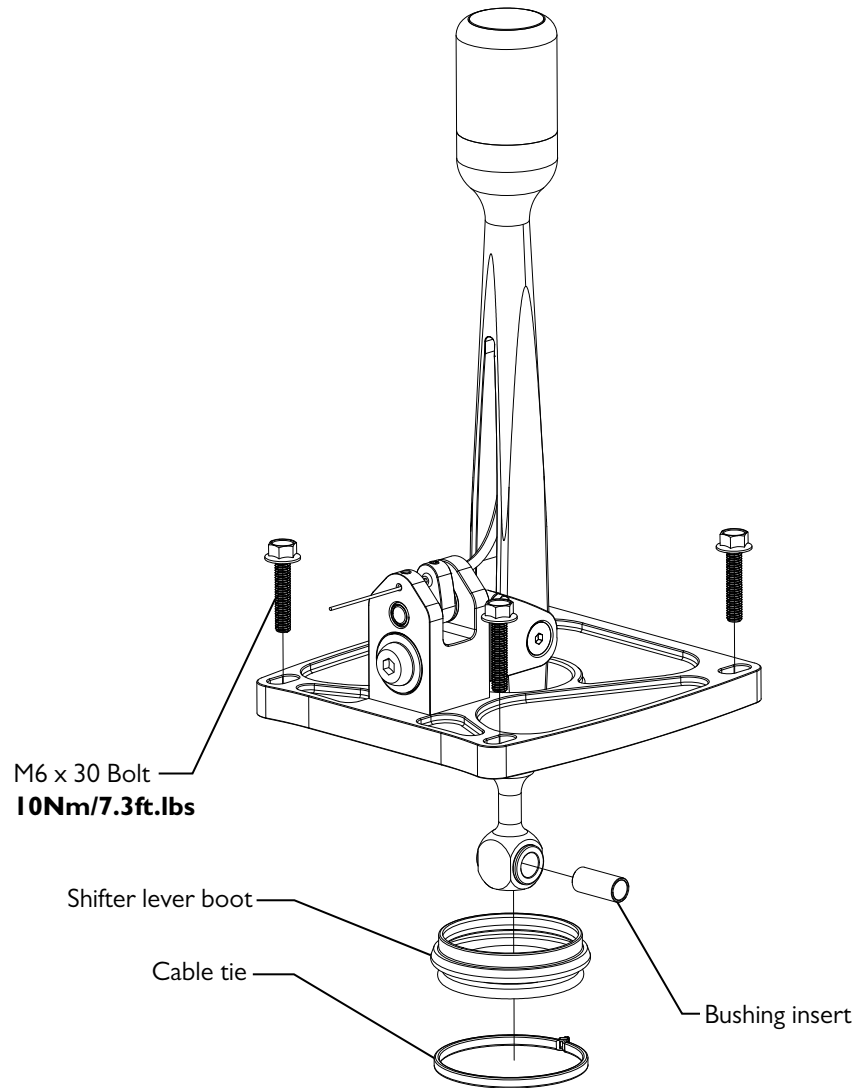

5. Ensure the Bushing insert is installed, then connect the lever to the OEM linkage using the OEM bolt

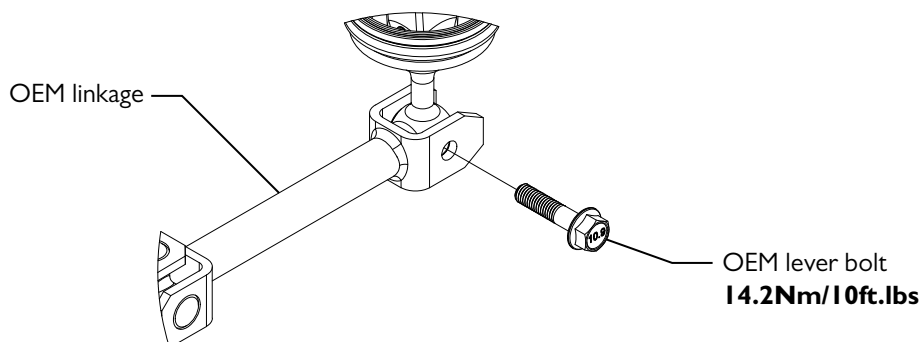



350Z / 370Z SHORT SHIFTER ASSEMBLY GUIDE

1. Fully adjust the adjustment screws outwards
2. Place the shifter lever into **REVERSE** gear
3. Adjust the set screw inwards and stop just before contact is made with the Lockout shaft
4. Hold adjustment screw in place and lock the adjuster nut
5. Confirm smooth operation into 5/6 gear without getting stuck on reverse gate, if contact is made adjust the set screw further inwards until smooth operation is achieved

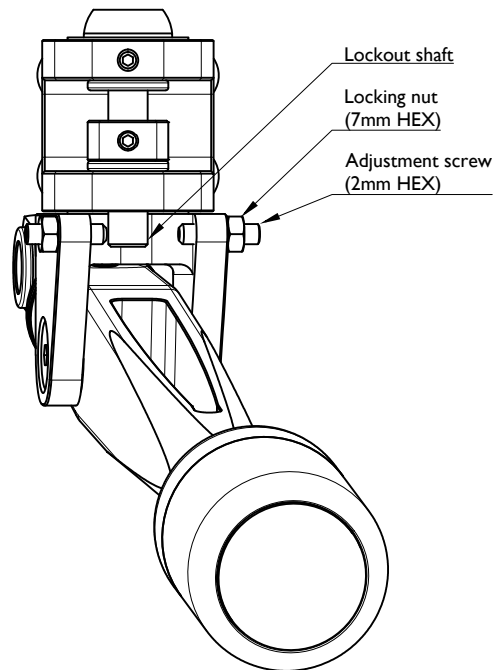

5. Place the shifter into **FIRST** gear
6. Repeat the process above for setting the adjustment screw

