

Z334-KNCK 1/2

COILOVER SPACING - 50MM

USE SUPPLIED COARSE
THREAD BOLTS FOR BREMBO
CALIPER AND FINE THREAD
BOLTS FOR THE OEM CALIPER

BREMBO - M12 x 1.75 x 25
OEM - M12 x 1.25 x 30

TRACTION ROD LENGTH
350Z: 332 mm
370Z: 272 mm
TRACTION ARM SPACING - 40MM

CAMBER ARM LENGTH
350Z: 317 mm
370Z: 318 mm
CAMBER ARM SPACING - 40MM

TOE LINK LENGTH
350Z: 445mm
370Z: 445mm
TOE LINK SPACING
- 50MM

DRUM BRAKE CABLE

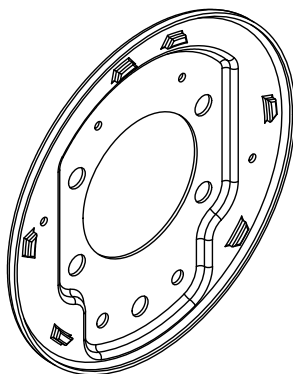

IMPORTANT!
HAND BRAKE BACKING PLATE
MUST BE USED FOR CORRECT
BRAKE CALIPER OFFSET

DUST SHIELD SECTION CAN BE
TRIMMED FOR DUAL CALIPERS
OR REMOVED

*ARM LENGTHS GIVEN FOR 0 STATIC ALIGNMENT WITH RIDEHEIGHT MEASURED
FROM LOWER REAR LINK (CAMBER ARM) BOLT CENTER FROM GROUND: 150mm

ALIGNMENT	CAMBER ANGLE	TOTAL TOE IN
RACING	-2°..-3°	0..2mm
DRIFTING	0°..-0,5°	2..10mm

Z334-KNCK 2/2

TIGHTEN BOLT TO 110 Nm (80 lbs-ft)

IMPORTANT!

BALL JOINT NUT TO BE TIGHTENED
BEFORE INSTALLING THE AXLE

TIGHTEN BALL JOINT NUT TO 85 Nm (63 lbs-ft)

TIGHTEN BOLTS TO 88 Nm (65
lbs-ft)

RE-USE OEM HUB BOLTS,
TIGHTEN BOLTS (4x) TO 88
Nm (65 lbs-ft)

TIGHTEN AXLE NUT TO
240 Nm (177 lbs-ft)

TIGHTEN BOLT TO
88 Nm (65 lbs-ft)

USE ALL 3x SPACERS FOR MOUNTING
OEM DRUM BRAKE

TIGHTEN DRUM BRAKE CARRIER NUTS
(IF USED) TO 88 Nm (65 lbs-ft), BOLT TO
12Nm (9 lbs-ft)

TIGHTEN BOLT TO
87,5 Nm (65 lbs-ft)

