



# Z33X-BMCS

 45 (4.6, 33)

 72.3 (7.4, 53)

1. REMOVE THE FRONT STRUT BRACE FOR ACCESS.
2. WHILE THE VEHICLE IS ON THE GROUND, REMOVE THE STRUT TOP BOLTS AND RE-INSTALL THEM WITH THE STRUT TOP BRACKET IN BETWEEN.
3. HR MODELS (DUAL INTAKE) WILL REQUIRE THE INTAKE PIPE TO BE REMOVED FOR BETTER ACCESS.
4. USING THE EXISTING HOLE IN THE STRUT TOP BRACKET, USE A 10MM DRILL BIT TO DRILL THROUGH THE MASTER CYLINDER PARTITION WALL (AS SHOWN BY ARROW).
5. SCREW THE ADJUSTMENT STUD AND NUT ALL THE WAY INTO THE ANGLED STOPPER SLEEVE. (FACTORY NON-BREMBO VEHICLES REQUIRE THE LONGER ADJUSTMENT STUD PROVIDED).
6. INSTALL THE ANGLED STOPPER SLEEVE ON TO THE STRUT TOP BRACKET USING THE ANGLE SPACER AND BOLT. TIGHTEN FINGER TIGHT.
7. PRESS THE BMC STOPPER SEAT ON TO THE END OF THE ADJUSTMENT STUD. TURN THE ADJUSTMENT STUD ANTICLOCKWISE UNTIL IT IS IN CONTACT WITH THE MASTER CYLINDER. THEN TURN AN ADDITIONAL 3 FULL TURNS. LOCK IN THE PRELOAD BY TIGHTENING THE JAM NUT CLOCKWISE.
8. HOLD THE SLEEVE AND TIGHTEN THE BOLT THROUGH THE STRUT TOP BRACKET TO 10Nm (7.4 ft-lbs).
9. REINSTALL ANY REMOVED INTAKE COMPONENTS, AND THE FRONT STRUT BAR USING THE TORQUE SPECS PROVIDED.

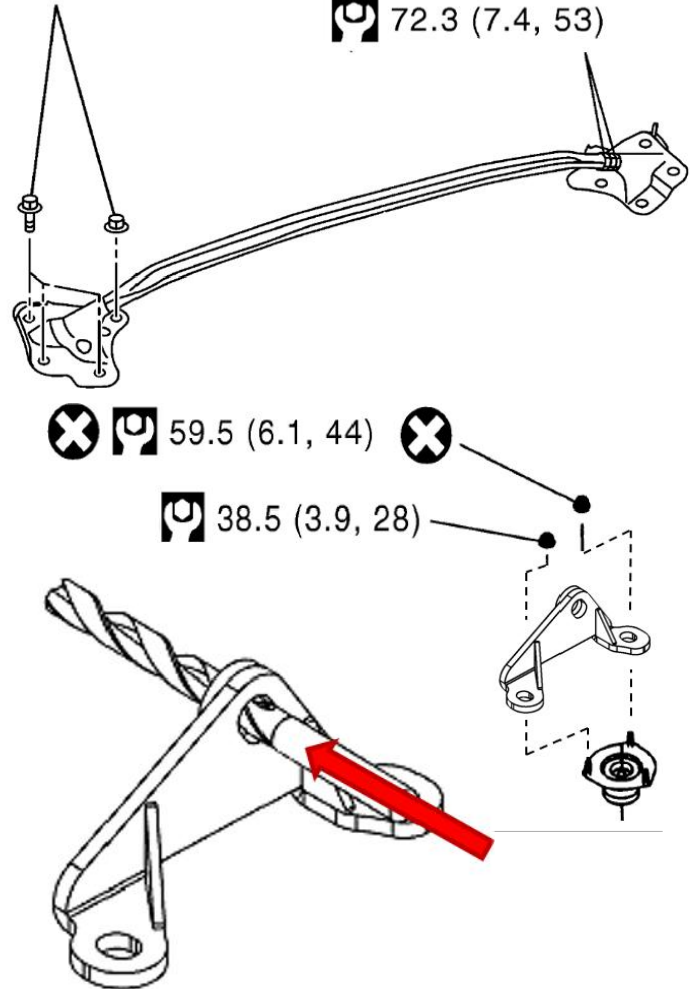

8	NON-BREMBO ADJUSTMENT STUD	1
7	M10 NUT	1
6	M10 BOLT	1
5	BMCS STOPPER SEAT	1
4	BREMBO ADJUSTMENT STUD	1
3	ANGLED STOPPER SLEEVE	1
2	STRUT TOP BRACKET	1
1	ANGLE SPACER	1
Item	Description	Qty
Parts List		

