

Z34X-SLVE

WELD IN SLEEVE

*Use supplied paper guide or download
from GKTECH website and print*

PATH = OEM Pathfinder diff cover
GK = GKTECH Billet diff cover

Place overtop of the OEM diff bush housing

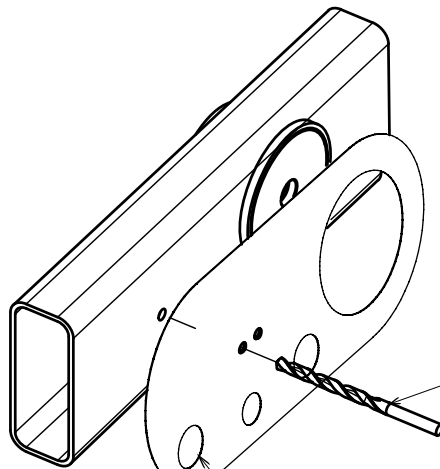
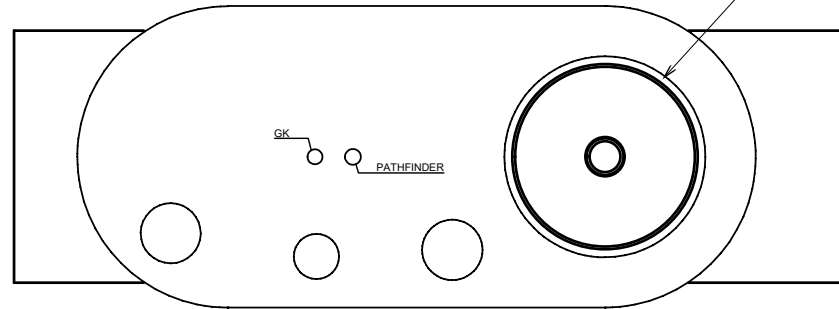

Use regular drillbit to make a
pilot hole for holesaw / step bit
Metric - **6.0mm**
Imperial - **1/4"**

Line up this hole inside subframe

Guide turned over and facing inwards

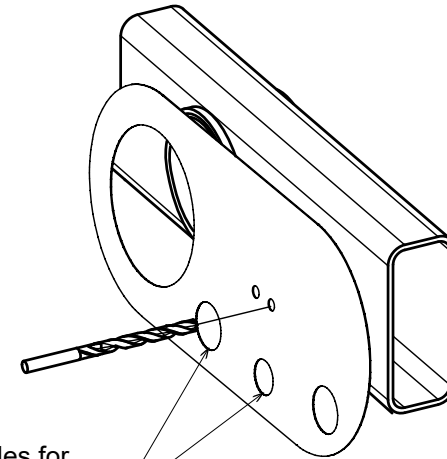

Line up these two holes for
outside of subframe

Z34X-SLVE

WELD IN SLEEVE

Use holesaw to drill front hole
Metric - 76mm
Imperial - 3"

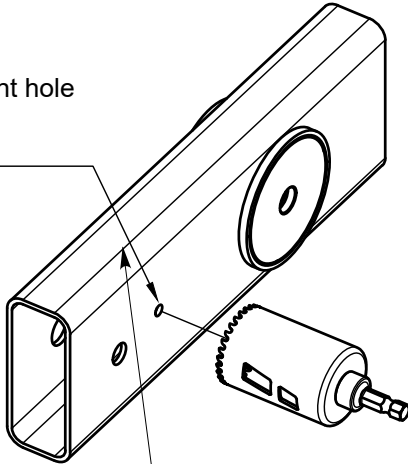

On Z34 subframes, the holesaw will cut all the way through the top of the subframe, this is expected and welded the bush in will add this strength back in plus more

Use holesaw to drill rear hole

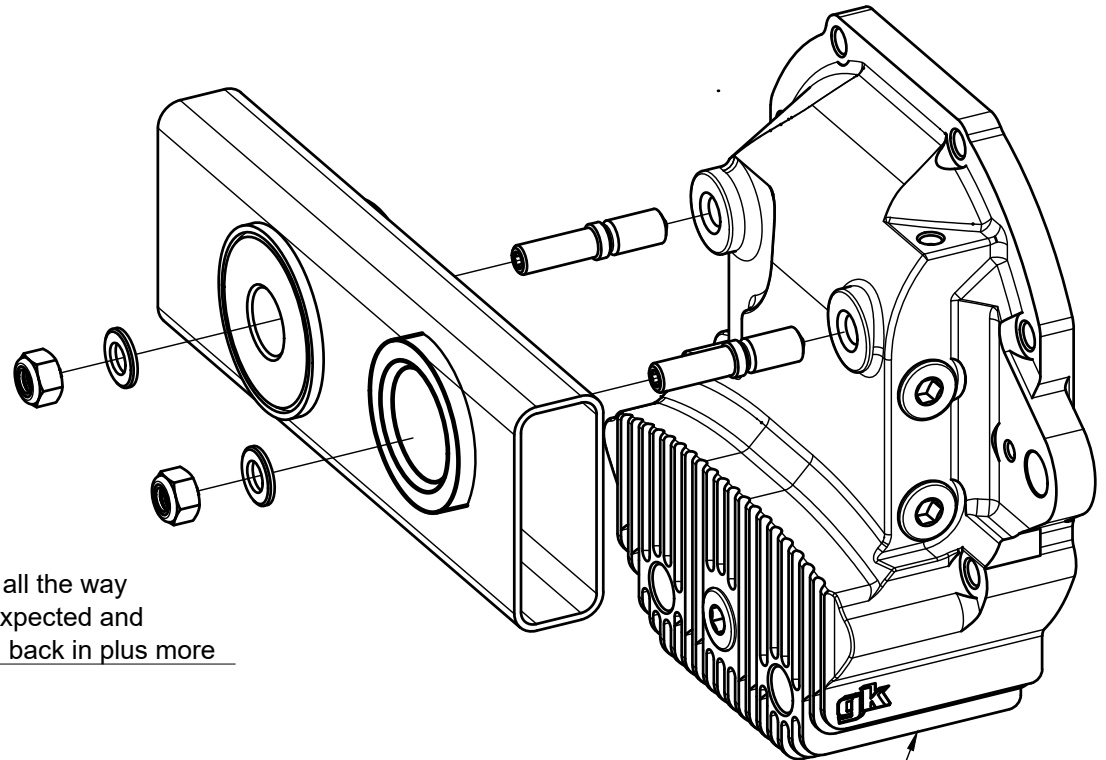
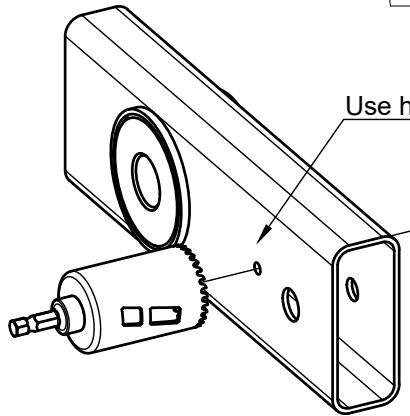

Install the differential with GK or Pathfinder cover to ensure bushing alignment
Tac weld in place before removing differential and fully welding
Welding should mimic the OEM welding